

**Materials List**

Item	Part Name	Materials
1	Body	Cast Iron: ASTM A126CL. B , DIN1691 GG25, EN 1561 EN-GJL-200; GB12226 HT200; Ductile Cast Iron: ASTM A536 65-45-12, DIN 1693 GGG40, EN1563 EN-GJS-400-15, GB12227 QT450-10; Stainless Steel: ASTM A351 CF8, CF8M; CF3, CF3M; Carbon Steel: ASTM A216 WCB
2	Stem	Zinc Plated Steel; Stainless Steel: ASTM A276 Type 316, Type 410, Type 420; ASTM A582 Type 416;
3	Taper Pin	Stainless Steel: ASTM A276 Type 304, Type 316; EN 1.4501;
4	Seat	NBR, EPDM, Neoprene, PTFE, Viton;
5	Disc	Ductile Cast Iron (Nickel plated): ASTM A536 65-45-12, DIN 1693 GGG40, EN1563 EN-GJS-400-15, GB12227 QT450-10; Stainless Steel: ASTM A351 CF8, CF8M; CF3, CF3M; EN 1.4408, 1.4469; 1.4501; AL-Bronze: ASTM B148 C95400;
6	O-Ring	NBR, EPDM, Neoprene, Viton;
7	Bushing	PTFE, Nylon, Lubricated Bronze;
8	Key	Carbon Steel

This buyer can select material as per materials list. The customer may mark the material and temperature used, Our company may select instead. When the medium and temperature is special, please consult with our company.

Seat Temperature Ratings

Material		NBR	Neoprene	EPDM	Hypalon	Viton	PTFE
Temperature Ratings	°C	-20~100	-40~100	-40~120	-32~135	-12~230	-50~200
	°F	-4~212	-40~212	-40~248	-25.6~275	10.4~446	-58~392

Seat materials are capable of withstanding lower temperatures without damage. However, the elastomer becomes hard and torques increase. Some flow media may further restrict the published temperature limits or significantly reduce seat life.



Series F101 U-Section Wafer Type Butterfly Valve

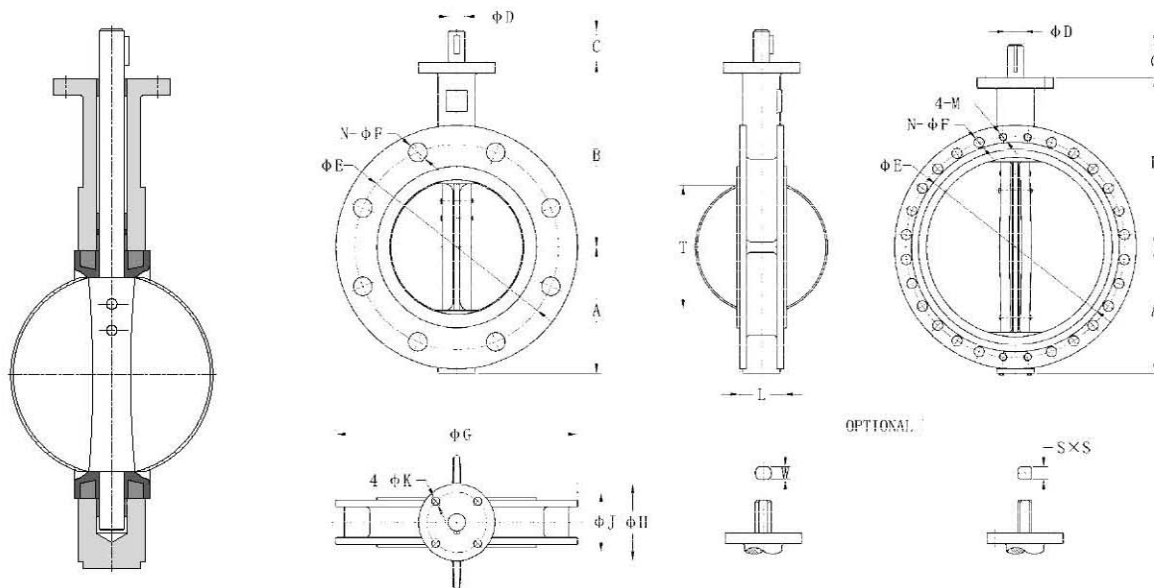

Dimensions List (mm)

Size		E					N-F/(4-M)					G			H	J	I-K	L	T	S	W			
mm	inch	A	B	C	D	ANSI 125/150	PN10	PN16	ANSI 125/150	PN10	PN16	ANSI 125/150	PN10	PN16	ANSI 125/150	PN10	PN16							
40	1½	70	145	32	12.7	98.4	110	110	4-16	4-18	4-18	127	150	150	65	50	4-7	33	27	9	10			
50	2	76	162	32	12.7	120.7	125	125	4-19	4-18	4-18	152	165	165	65	50	4-7	42	32	9	10			
65	2½	80	174	32	12.7	139.7	145	145	4-19	4-18	4-18	178	185	185	65	50	4-7	45	47	9	10			
80	3	90	181	32	12.7	152.4	160	160	4-19	4-18	8-18	191	200	200	65	50	4-7	45	65	9	10			
100	4	110	200	32	15.9	190.5	180	180	8-19	8-18	8-18	229	220	220	90	70	4-9.5	52	90	11	12			
125	5	125	213	32	19.1	215.9	210	210	8-22	8-18	8-18	254	250	250	90	70	4-9.5	54	111	14	14			
150	6	143	225	32	19.1	241.3	240	240	8-22	8-22	8-22	279	285	285	90	70	4-9.5	56	145	14	14			
200	8	175	260	38	22.2	298.5	295	295	8-22	8-22	12-22	343	340	340	125	102	4-11.5	60	193	17	17			
250	10	203	292	38	28.6	362	350	355	12-25	12-22	12-26	406	395	405	125	102	4-11.5	66	241	22	22			
300	12	245	337	38	31.8	431.8	400	410	12-25	12-22	12-26	483	445	460	125	102	4-11.5	77	292	22	24			
350	14	277	368	45	31.8	476.3	460	470	12-29	16-22	16-26	533	505	520	125	102	4-11.5	77	325	22	24			
400	16	308	400	51	33.3	539.8	515	525	16-29	16-26	16-30	597	565	580	210	165	4-22	86	380	27	27			
450	18	342	422	51	38.1	577.9	565	585	16-32	20-26	20-30	635	615	640	210	165	4-22	105	428	27	27			
500	20	374	479	64	41.3	635	620	650	20-32	20-26	20-33	699	670	715	210	165	4-22	130	474	27	32			
600	24	459	562	70	50.8	749.3	725	770	20-35	20-30	20-36	813	780	840	210	165	4-22	152	575	36	36			
700	28	520	624	72	55	—	840	840	—	24-30	24-36	—	895	910	300	254	8-18	165	674	—	—			
750	30	545	650	72	55	914.4	900	900	24-35 4-1¼"	24-33	24-36	984	965	970	300	254	8-18	167	726	—	—			
800	32	575	672	72	55	—	950	950	—	24-33	24-39	—	1025	1025	300	254	8-18	190	771	—	—			
900	36	635	768	77	75	1085.9	1050	1050	28-41 4-1½"	24-33 4-M30	24-39 4-M36	1168	1115	1125	300	254	8-18	207	839	—	—			
1000	40	685	823	85	85	—	1160	1170	—	24-36 4-M33	24-42 4-M39	—	1230	1255	300	254	8-18	216	939	—	—			
1050	42	765	858	85	85	1257.3	—	—	32-41 4-1½"	—	—	1346	—	—	300	254	8-18	256	997	—	—			
1200	48	839	940	150	92	1422.4	1380	1390	40-41 4-1½"	28-39 4-M36	28-48 4-M45	1511	1455	1485	350	298	8-22	276	1125	—	—			

✦ Please contact manufacturer if you want more flange standards.